



FOR LEASE: SMALL DOWNTOWN RETAIL SHOPS

694 SF and 1,730 SF
Downtown Retail Opportunities

7 & 11 W. Canon Perdido Street, *Santa Barbara, CA 93101*

PROPERTY DETAILS

- 58,762 square foot mixed-use building on the corner of State and Canon Perdido Street
- Anchored by H&M and Kariella on the ground floor and Cappello & Noel Law on the 2nd floor
- Historical Santa Barbara building, originally constructed in 1903, rebuilt after the 1925 earthquake and seismically upgraded in 1992



01 – The Howard Canfield Building today.



02 – Historical photo of the Howard Canfield Building.



WWW.INVESTECRE.COM | 200 E. CARRILLO STREET, SUITE 200 | SANTA BARBARA, CALIFORNIA 93101

CROSBY SLAUGHT
805.690.1017 | CROSBY@INVESTECRE.COM
DRE LIC. NO. 01939629

ISAIAH BOLTON
805.690.1021 | ISAIAH@INVESTECRE.COM
DRE LIC. NO. 02136939



03 – View of the Howard Canfield Building from Canon Perdido Street.



04 – Kariella interior at 833 State Street.

PROPERTY HIGHLIGHTS

The Howard Canfield Building is located at the highly walked and visible corner of State and Canon Perdido Street. Directly adjacent to the Paseo Nuevo mall and located on the premier 800 block of State Street, this highly distinguished building's retail tenant mix includes international retailer H&M, as well as local retailers Kariella and Blue Owl Restaurant.

DEMOGRAPHIC INFORMATION (2018, ESRI)

1 mile

- Population: 30,665
- Daytime Population: 57,686
- Med. Home Value: \$988,411
- Avg. Household Income: \$79,661
- Avg. Disposable Income: \$60,558

3 miles

- Population: 91,845
- Daytime Population: 114,310
- Med. Home Value: \$1,192,218
- Avg. Household Income: \$112,367
- Avg. Disposable Income: \$80,142

5 miles

- Population: 114,394
- Daytime Population: 143,721
- Med. Home Value: \$1,219,204
- Avg. Household Income: \$118,870
- Avg. Disposable Income: \$83,730

7 W. CANON PERDIDO STREET

- 694 square feet
- Rental Rate: \$3.00 NNN
- NNN: \$1.20
- Turnkey for boutique retailer

11 W. CANON PERDIDO STREET

- 1,730 square feet
- Rental Rate: \$2.50 NNN
- NNN: \$1.24
- Two-story space with large windows facing Canon Perdido Street

FLOOR PLAN



1 W. CANON PERDIDO STREET

- 7,306 square feet
- Opportunity for Retail or Office User
- Available: Now
- Lower Level Space, just off State Street



FLOOR PLAN

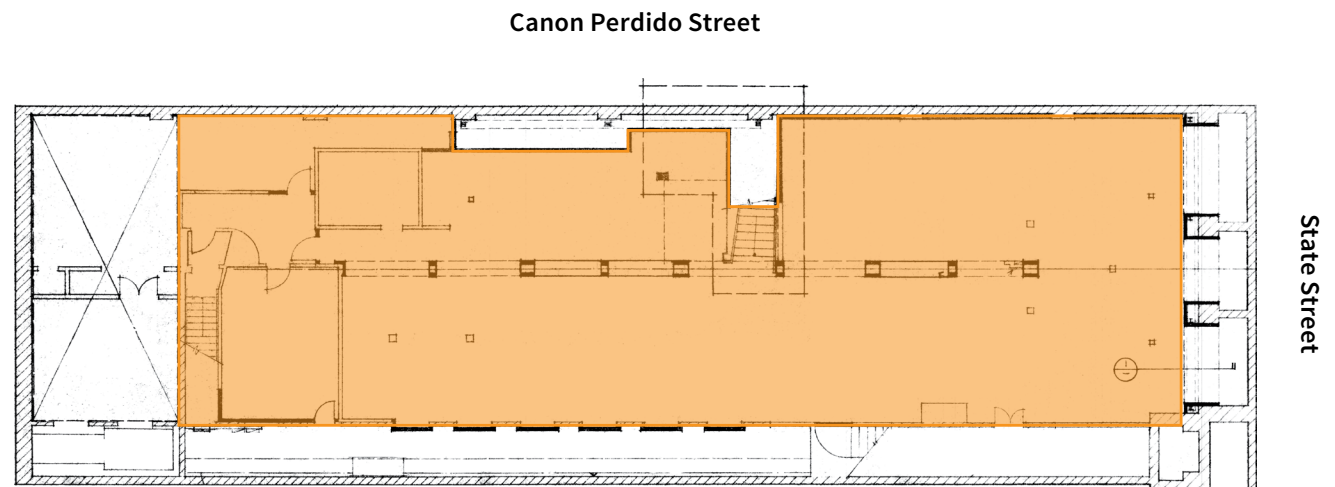

FOR LEASE: SMALL DOWNTOWN RETAIL SHOPS ▶ The Howard-Canfield Building

